

VITICROP

Mounted reversible sprayer



VITICROP

Mounted reversible sprayer

The mounted reversible sprayer VITICROP has been specifically designed for vineyard maintenance. The VITICROP was made for inter-row spacing from 1,4 m to 3,0 m.

The VITICROP 12 and 16 discs have the particularity to be extensible and reversible.



+ HITCH

Mounted 3 points with clevises category n°1N, 1 and 2 to suit all types of tractors. 3rd point height adjustable.

+ CHASSIS

Steel beam 100 x 80 x 6 mm and 80 x 80 x 8 mm.

+ ARRAYS

Mounted on parallelogram, angle adjustment with pinout 3 positions from 8 to 24°.
Crenellated discs Ø510 x 3,5 mm (VITICROP 8) and Ø560 x 4,5 mm (VITICROP 12/16).



+ SHAFT

High resilience manganese-silica steel with square bearings of 30 mm.

DISCS FOR STRADDLE TRACTOR



+ BEARING

Self-aligning ball bearings.
Manganese-silica steel square shaft of 30 mm.

+ CHASSIS

Steel beam 100 x 80 x 6 mm.

VITICROP 8 DISCS

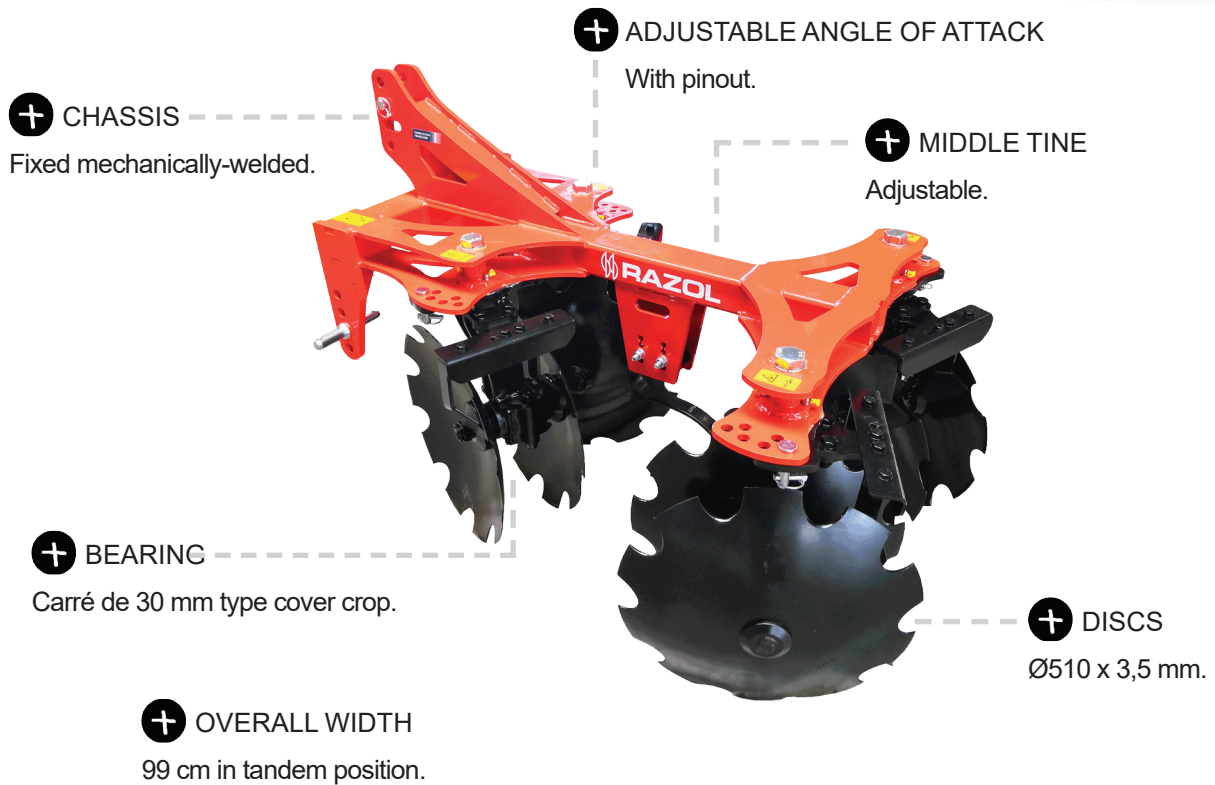

HYDRAULIC ADJUSTMENT

The VITICROP 12 and 16 can be hydraulically widen with 1 double output cylinder and a moving system with 4 factory set arms. The tool can also be lift with an hydraulic cylinder which allow you to make easier turn in short pound et to move the weight to the front of the tractor for on road transport.

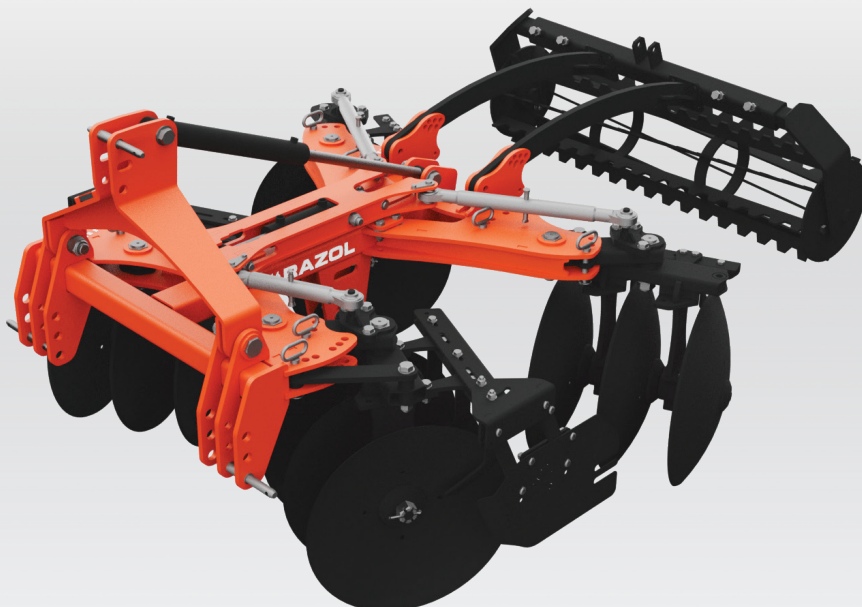

CONFIGURATIONS

STANDARD TANDEM

Stubble cultivation, residue burying and vineyard maintenance.

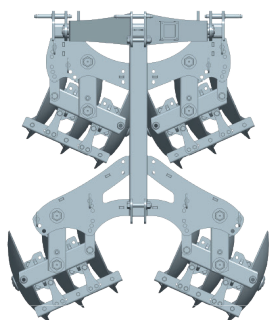

HILLING POSITION

Protection of vine against frost, promotes water flow.

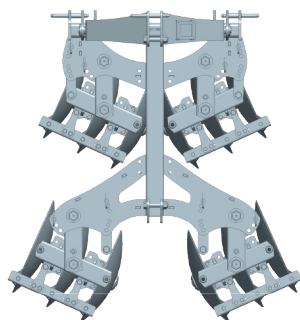

DEHILLING POSITION

Promotes vine grow and prevent root formation on top of graft point.

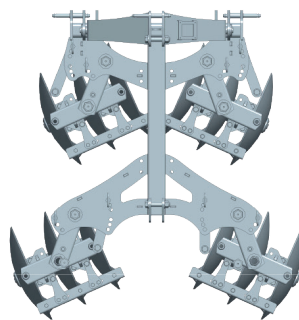

VITICROP 8 DISCS

Working and overall width of 99 cm

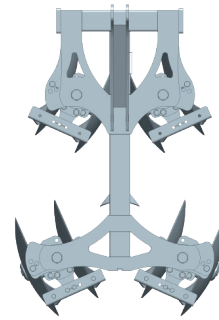

DISCS, TINE AND BEARINGS



Disc Ø510

- Mounted on square shaft 30 mm
- Thickness available 3,5 mm



Disc Ø560

- Mounted on square shaft 30 mm
- Thickness available 4,5 mm



Flexible middle tine 45 x 10 mm

Triangle share 175 x 5 mm



Square bearing of 30 mm

- Cast iron lids and bearing housing
- Steel sheath
- Tapered roller bearing



Standard protection

ROLLER

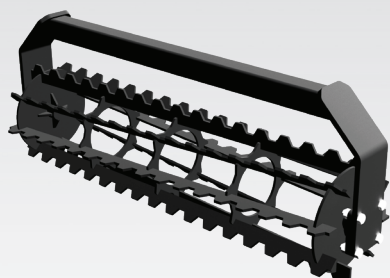

+ SERRATED IRONS

Ø360 mm, 8 flats
Flanged ball bearing Ø40 mm

- Dry and hilly land
- Silt and sand
- Aggressive serrated irons
- Weight : 90 kg/m

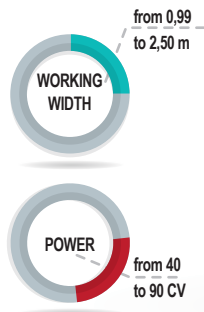

- CHASSIS steel beam 100 x 80 x 6 mm
- BEARING with cast iron lids and housing
- SHEATH machined steel
- TAPERED ROLLER bearing

- SQUARE SHAFT manganese-silica steel of 30 mm
- MIDDLE TINE height adjustment with duckfoot share
- SIDE DEFLECTORS AND PROTECTIONS available in option

Standard equipments



Specifications Viticrop 8 discs	Specifications Viticrop 12 and 16 discs
<ul style="list-style-type: none"> Hitch category n°1 and 2, with 3rd point height adjustable Reversible arrays Angle set with 3 positions from 8 to 24° Discs Ø510 x 3,5 mm 	<ul style="list-style-type: none"> Hitch crossmember 80 x 80 x 8 mm Hitch category n°1N, 1 and 2, with 3rd point height adjustable Arrays mounted on parallelogram Angle set with 3 positions from 8 to 24° Discs Ø560 x 4,5 mm Working width with manual set using pinout (hydraulic in option)

VITICROP	8 discs	12 discs	16 discs (12 + 4)
Working width	0,99 m	1,45 m / 1,65 m / 1,80 m	1,80 m / 2,00 m / 2,15 m
Number of bearings	4	8	8
Space between discs	205 mm	205 mm	205 mm
Number of discs	8	12	16
Weight	310 kg	590 kg	715 kg

Accessories :

- Side deflector
- Bearing protection 30 mm
- Hydraulic lift (Viticrop 12 and 16)
- Hydraulic working width set (Viticrop 12 and 16)

Roller

SERRATED IRONS	Working width		
Ø360 mm, 8 irons	Weight	1,34 m 127 kg	1,64 m 154 kg

Discs for straddle tractor

	2 arrays of 2 discs Ø510 x 3,5 mm	2 arrays of 3 discs Ø510 x 3,5 mm	2 arrays of 4 discs Ø510 x 3,5 mm
Weight	92 kg	104 kg	136 kg



Devices **with INDEPENDENT DISCS**

SKYRON fixed independent disc harrow
SKYRON folding independent disc harrow
SKYRON self-supporting independent disc harrow



Devices **with DISCS X**

ORBYS self-supporting X combining sprayer
ZÉNITH RGH self-supporting X combining sprayer
ZÉNITH RZH self-supporting X combining sprayer
ZÉNITH RJH self-supporting X combining sprayer
PHÉNIXTGX self-supporting X sprayer
PHÉNIXTBX self-supporting X sprayer



Devices **with DISCS V**

CWH - CWHR super heavy self-supporting V Cover Crop
SYNCHRONIC CIN self-supporting V Cover Crop
CLH - CVH heavy self-supporting V Cover Crop
CIH - CJH self-supporting V Cover Crop



Devices **with SUPPORTED DISCS**

VITICROP mounted X sprayer
VINIDISC mounted disc harrow
TXL mounted X sprayer
TRW heavy-duty mounted reversible sprayer
CCW - CCU mounted reversible sprayer



Devices **for ROLLING**

ROLLPACK self-supporting cast iron roller
TORO - RVH self-supporting cast iron roller
RVH EVO self-supporting steel smooth roller



Devices **with TINES**

KILIS - KILIS R combined cultivator with flexible tines
TÉOS - TÉOS R stubble cultivator with curved tines 3 rows



Devices **for LOOSENING**

ARASOL AVLE supported subsoiler
ARASOL AVS - AVR supported subsoiler
ARAPLOW ACV supported decompactor
ARAPLOW ACM - ACMH supported decompactor
ARAMULCH ADM - ADMH supported decompactor
DVV supported subsoiler for vineyard and orchards



Devices **for SPRING**

BLI - BMI - BSI folding and fixed mounted cultivator